

52 COMMERCIAL MEDICAL SUPPORT VESSEL

Specifications

Length overall:	18.00 metres
Measured length:	15.80 metres
Waterline length:	13.40 metres
Beam amidships:	4.90 metres
Freeboard at bow:	2.00 metres
Freeboard at stern:	1.40 metres
Draft:	1.20 metres
Displacement (loaded):	23.0 tonnes
Fuel capacity:	2600 litres
Water tank capacity:	300 litres
Engine Make/Model:	twin C12 Catapillar 700hp each
Max Speed (loaded):	28 knots
Cruising speed:	20 knots
Chamber:	CM1200 Model 3208 twin lock Recompression chamber

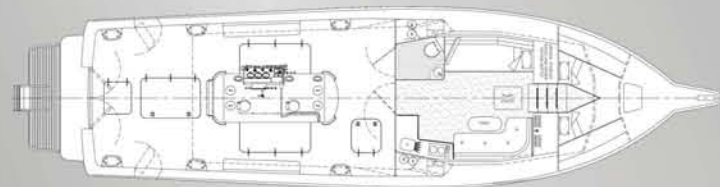

STEBER™



52

COMMERCIAL MEDICAL SUPPORT VESSEL



STEBER INTERNATIONAL
STEBER CRAFT PTY. LTD.

ABN 99 000 522 163



PO Box 90 Taree NSW 2430
6 Elizabeth Avenue - Taree NSW 2430 Australia
Phone +61 2 6552 2577 Fax +61 2 6551 0344
Email mail@steber.com.au Web www.steber.com.au

552-03-70

WWW.STEBER.COM.AU





STEBER

